

2009' E-Catalogue

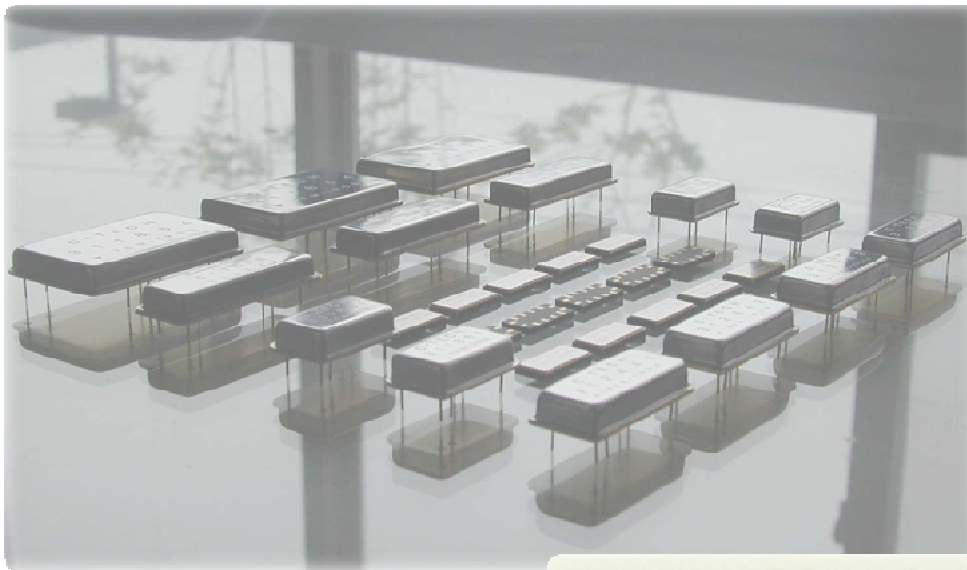

**Microwave
Bandpass
Filter**

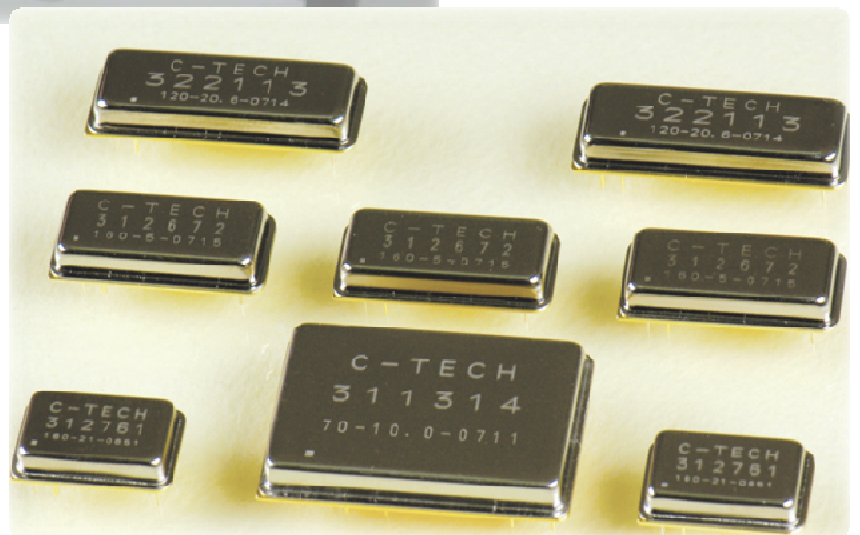

Microwave Components & Microwave Filters

Application Guide		Microwave Filters	Voltage Controlled Oscillators	Dielectric Resonators	L.C filters
Application	Products				
TRS		☑	☑	☑	
Mobile Telephone		☑	☑	☑	
GPS		☑	☑	☑	
PCS		☑	☑	☑	☑
WLL		☑	☑	☑	☑
FPLMTS		☑	☑	☑	☑
MMDS		☑	☑	☑	
Wireless LAN		☑	☑	☑	☑
VAST/HDTV					☑
VCR, TV, CATV					☑
Cordless Phones		☑	☑	☑	☑

<Communication System Block Diagram>

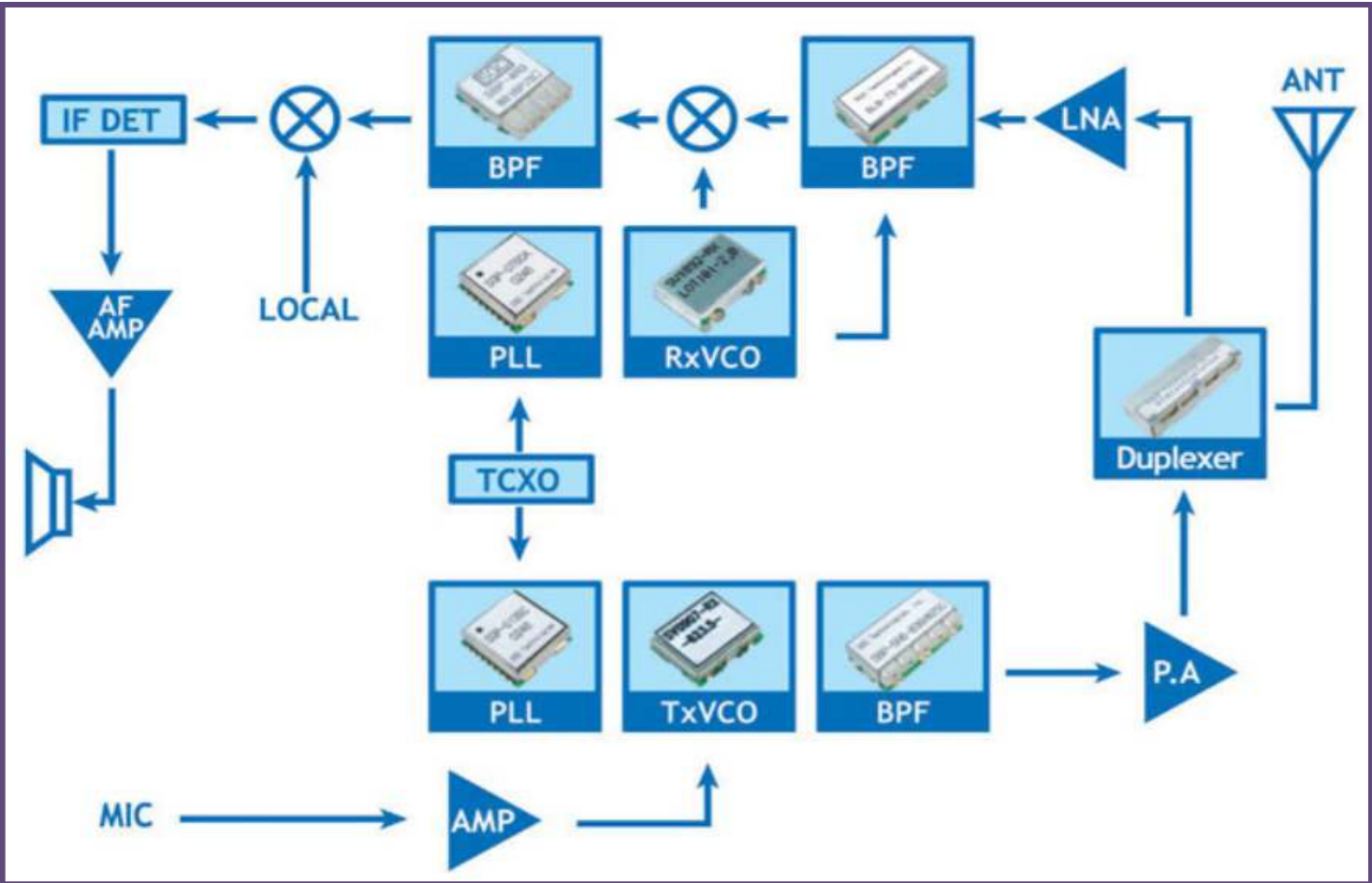

VCOs (Voltage Controlled Oscillators)

VCO (CV0504-1.8mm Series)				Item Code		CV0504-1.8mm Series		
				Application		-		
Part Number	Frequency (Mhz)	Supply Voltage (V)	Control Voltage (V)	Control Voltage Sensitivity (Mhz/V)	Output Level	Power Consumption (Max/mA)	C/N dBc/Hz	2nd Harmonics (dBc)
CV0504-967RX	954~980	2.8	0.5~2.5	≥13.0	0 ± 3	≤8.5	≥100 (10)	-10
CV0504-967RX	954~980	3.0	0.5~2.5	≥13.0	0 ± 3	≤7.5	≥100 (10)	-10
CV0504-1100RX	1090~1110	3.0	0.3~2.3	≥15.0	-1 ± 3	≤10.0	≥115 (60)	-15
CV0504-1635RX	1620~1650	3.0	0.5~2.5	≥15.0	0 ± 3	≤8.5	≥70 (1)	-10
CV0504-1750RX	1720~1780	3.0	0.5~2.5	≥30.0	0 ± 3	≤8.5	≥70 (10)	-10
CV0504-2139RX	2095.5~ 2182.5	2.85	0.3~2.3	≥43.5	0 ± 3	≤15.0	≥113 (60)	-10

VCO (CV0706 & CV1007 2.0mm Series)				Item Code		CV0706-2.0mm & CV1007-2.0mm		
				Application		-		
Part Number	Frequency (Mhz)	Supply Voltage (V)	Control Voltage (V)	Control Voltage Sensitivity (Mhz/V)	Output Level	Power Consumption (Max/mA)	C/N dBc/Hz	2nd Harmonics (dBc)
CV0706-748RX	738~758	3.0	0.5~2.2	≥30.0	-8 ± 3	≤5.0	≥90 (10)	-20
CV0706-2074RX	2014~2134	3.0	0.5~2.2	≥70.0	0 ± 3	≤10.0	≥84 (10)	-30
CV0706-2450RX	2400~2500	3.0	0.4~2.4	≥55.0	-1 ± 4	≤12.0	≥75 (10)	-15
CV1007 2400 TX/RX	1199~1245	3.0	0.5~2.5	≥23.0	≥ -11	≤10.0	≥90 (25)	-15
	1144~1190	3.0	0.5~2.5	≥23.0	≥ -11	≤10.0	≥90 (25)	-15

VCO (CV0706 & CV1007 2.0mm Series)				Item Code		CV0706-2.0mm & CV1007-2.0mm		
				Application		-		
Part Number	Frequency (Mhz)	Supply Voltage (V)	Control Voltage (V)	Control Voltage Sensitivity (Mhz/V)	Output Level	Power Consumption (Max/mA)	C/N dBc/Hz	2nd Harmonics (dBc)
CV0907-805RX	799 ~ 811	5.0	1.0~5.0	≥3.0	≥ -4	≤10.0	≥90 (10)	-30
CV0907-815TX	805 ~ 825	3.0	0.5~2.5	≥10.0	≥ -4	≤6.5	≥97 (10)	-15
CV0907-833RX	797 ~ 869	5.0	1.0~5.0	≥18.0	≥ -4	≤10.0	≥90 (10)	-30
CV0907-838RX	788 ~ 888	5.0	0.5~4.5	≥25.0	+3 ± 2	≤15.0	≥97 (10)	-20
CV0907-862RX	856 ~ 868	5.0	1.0~5.0	≥3.0	≥ -4	≤10.0	≥90 (10)	-30
CV0907-1188RX	1138 ~ 1238	5.0	0.5~4.5	≥25.0	+3 ± 2	≤15.0	≥94 (10)	-18

VCO (CV0706 & CV1007 2.0mm Series)				Item Code		CV0706-2.0mm & CV1007-2.0mm		
				Application		-		
Part Number	Frequency (Mhz)	Supply Voltage (V)	Control Voltage (V)	Control Voltage Sensitivity (Mhz/V)	Output Level	Power Consumption (Max/mA)	C/N dBc/Hz	2 nd Harmonics (dBc)
CV1007-454TX	442 ~ 466	2.7	0.5~2.2	≥13.0	≥ +7	≤25.0	≥112(100)	-28
CV1007-454RX	441 ~ 467	2.7	0.5~2.2	≥13.0	≥ +7	≤25.0	≥112(100)	-30
CV1007-897TX	887 ~ 907	3.0	0.5~2.5	≥10.0	≥ -6	≤8.0	≥107 (25)	-25
CV1007-897RX	887 ~ 907	3.0	0.5~2.5	≥10.0	≥ -6	≤8.0	≥107 (25)	-25
CV1007-915TX	895 ~ 935	5.0	0.5~4.5	≥10.0	≥ -1	≤11.0	≥107 (25)	-25
CV1007-915RX	895 ~ 935	5.0	0.5~4.5	≥10.0	≥ -1	≤11.0	≥107 (25)	-25

VCO (CV0706 & CV1007 2.0mm Series)				Item Code		CV0706-2.0mm & CV1007-2.0mm		
				Application		-		
Part Number	Frequency (Mhz)	Supply Voltage (V)	Control Voltage (V)	Control Voltage Sensitivity (Mhz/V)	Output Level	Power Consumption (Max/mA)	C/N dBc/Hz	2 nd Harmonics (dBc)
SV1212- 61.4RX	51.4~71.4	5.0	1.0~12.0	≥1.82	+1.5±2.5	≤9.0	≥115(10)	-10
SV1212-63RX	53~73	5.0	0.5~4.5	≥5.0	+1.5±2.5	≤9.0	≥115(10)	-10
SV1212-310RX	295~325	5.0	0.5~4.5	≥7.5	0 ± 2.0	≤8.0	≥90(10)	-30
SV1212-1195RX	1145~1245	3.3	0.3~3.0	≥37.0	+8 ±2.0	≤15.0	≥95 (10)	-8
SV1212-3095RX	2990~3200	5.0	0.0~5.0	≥42.0	≥ 0	≤40.0	≥95(10)	-15